

## UNION TEE

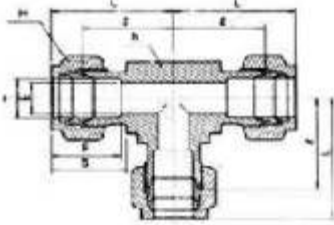

Part No.	Tube O.D. T mm	E mm	h mm	H mm	F	G	I	L
KFI-UT02	2	1.7	9.5	12	12.9	15.3	15.7	22.3
KFI-UT03	3	2.4	9.5	12	12.9	15.3	15.7	22.3
KFI-UT04	4	2.4	12.7	12	13.7	16.1	18.8	25.4
KFI-UT06	6	4.8	12.7	14	15.3	17.7	19.6	27.0
KFI-UT08	8	6.4	14.3	16	16.2	18.6	21.3	28.8
KFI-UT10	10	7.9	17.5	19	17.2	19.5	23.9	31.5
KFI-UT12	12	9.5	20.6	22	22.8	22.0	25.9	36.0
KFI-UT15	15	11.9	25.4	25	24.4	22.0	28.7	38.8
KFI-UT16	16	12.7	25.4	25	24.4	22.0	28.7	38.8
KFI-UT18	18	15.1	27.0	30	24.4	22.0	29.7	39.8
KFI-UT20	20	15.9	31.8	32	26.0	22.0	32.5	42.6
KFI-UT22	22	18.3	31.8	32	26.0	22.0	32.5	42.6
KFI-UT25	25	21.8	36.0	38	31.3	26.5	36.8	49.1

## KWIK FLEX INDUSTRIES

Plot No. X-18/7, Subodhi, MIDC Phase II, Dombivli (East) 421 201, INDIA  
 E-mail : [sales@kwikflex.com](mailto:sales@kwikflex.com) ; [kwikflex@vsnl.net](mailto:kwikflex@vsnl.net); Telefax : +91 251 2470102