

**UNION**

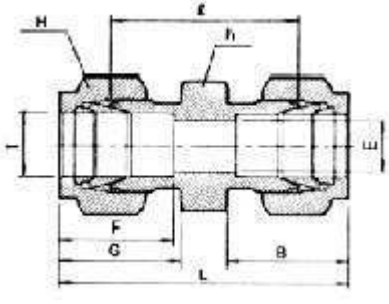

Part No.	Tube O.D.	E mm	h mm	H mm	F	G	I	L
	T mm							
KFI - U 02	2	1.7	12	12	12.9	15.3	22.4	35.6
KFI - U 03	3	2.4	12	12	12.9	15.3	22.1	35.3
KFI - U 04	4	2.4	12	12	13.7	16.1	24.1	37.3
KFI - U 06	6	4.8	14	14	15.3	17.7	26.2	41.0
KFI - U 08	8	6.4	15	16	16.2	18.6	28.2	43.2
KFI - U 10	10	7.9	18	19	17.2	19.5	31.0	46.2
KFI - U 12	12	9.5	22	22	22.8	22.0	31.0	51.2
KFI - U 15	15	11.9	24	25	24.4	22.0	31.8	52.0
KFI - U 20	20	15.9	30	32	26.0	22.0	34.8	55.0
KFI - U 22	22	18.3	30	32	26.0	22.0	34.8	55.0
KFI - U 25	25	21.8	35	38	31.3	26.5	40.4	65.0

**KWIK FLEX INDUSTRIES**

Plot No. X-18/7, Subodhi, MIDC Phase II, Dombivli (East) 421 201, INDIA  
 E-mail : [sales@kwikflex.com](mailto:sales@kwikflex.com) ; [kwikflex@vsnl.net](mailto:kwikflex@vsnl.net); Telefax : +91 251 2470102