

## REDUCING UNION

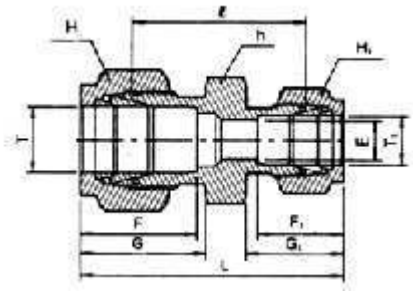

Part No.	Tube O.D.		E mm	h mm	H mm	H <sub>1</sub> mm	F	F <sub>1</sub>	G	G <sub>1</sub>	I	L
	T mm	T <sub>1</sub> mm										
KFI-RU06-03	6	3	2.4	14	14	12	15.3	12.9	17.7	15.3	24.6	38.6
KFI-RU06-04	6	4	2.4	14	14	12	15.3	13.7	17.7	16.1	25.4	39.4
KFI-RU08-06	8	6	4.8	15	16	14	16.2	15.3	18.6	17.7	27.4	42.3
KFI-RU10-06	10	6	4.8	18	19	14	17.2	15.3	19.5	17.7	29.5	44.5
KFI-RU10-08	10	8	6.4	18	19	16	17.2	16.2	19.5	18.6	30.0	45.1
KFI-RU12-06	12	6	4.8	22	22	14	22.8	15.3	22.0	17.7	29.5	47.0
KFI-RU-12-08	12	8	6.4	22	22	16	22.8	16.2	22.0	18.6	30.2	47.8
KFI-RU12-10	12	10	7.9	22	22	19	22.8	17.2	22.0	19.5	31.0	48.7
KFI-RU16-12	16	12	9.5	24	25	22	24.4	22.8	22.0	22.0	31.8	52.0
KFI-RU25-18	25	18	15.1	35	38	30	31.3	24.4	26.5	22.0	38.6	61.0
KFI-RU25-20	25	20	15.9	35	38	32	31.3	26.0	26.5	22.0	39.9	62.3

## KWIK FLEX INDUSTRIES

Plot No. X-18/7, Subodhi, MIDC Phase II, Dombivli (East) 421 201, INDIA  
 E-mail : [sales@kwikflex.com](mailto:sales@kwikflex.com) ; [kwikflex@vsnl.net](mailto:kwikflex@vsnl.net); Telefax : +91 251 2470102