

FEMALE BRANCH TEE

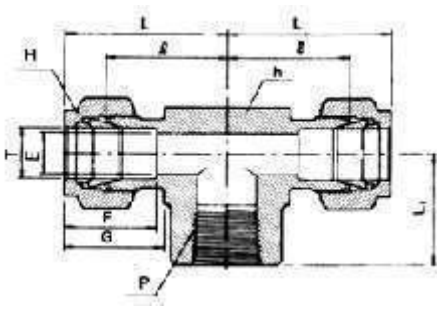

Part No.	Tube O.D. T mm	P (NPT)	E mm	h mm	H mm	F	G	I	L	L ₁
KFI-FBT06-02	6	1/8	4.8	12.70	14	15.3	17.7	19.6	27.0	19.0
KFI-FBT06-04	6	1/4	4.8	17.46	14	15.3	17.7	22.4	29.8	22.4
KFI-FBT06-06	6	3/8	4.8	20.63	14	15.3	17.7	22.4	31.7	22.4
KFI-FBT06-08	6	1/2	4.8	25.40	14	15.3	17.7	27.2	34.7	28.4
KFI-FBT08-02	8	1/8	6.4	15.87	16	16.2	18.6	23.1	29.9	19.0
KFI-FBT08-04	8	1/4	6.4	17.46	16	16.2	18.6	23.1	30.6	22.4
KFI-FBT08-06	8	3/8	6.4	20.63	16	16.2	18.6	25.2	32.4	22.4
KFI-FBT08-08	8	1/2	6.4	25.40	16	16.2	18.6	28.0	35.2	28.4
KFI-FBT10-04	10	1/4	7.9	20.63	19	17.2	19.5	25.9	33.5	22.4
KFI-FBT10-06	10	3/8	7.9	20.63	19	17.2	19.5	25.9	33.3	22.4
KFI-FBT10-08	10	1/2	9.5	25.40	19	17.2	19.5	26.2	33.6	22.4
KFI-FBT12-04	12	1/4	9.5	20.63	22	22.8	22.0	25.9	36.0	22.4
KFI-FBT12-06	12	3/8	9.5	20.63	22	22.8	22.0	25.9	36.0	22.4
KFI-FBT12-08	12	1/2	9.5	25.40	22	22.8	22.0	29.7	40.0	28.4
KFI-FBT16-08	16	1/2	12.7	25.4	25	24.4	22.0	28.7	38.8	28.7

KWIK FLEX INDUSTRIES

Plot No. X-18/7, Subodhi, MIDC Phase II, Dombivli (East) 421 201, INDIA
 E-mail : sales@kwikflex.com ; kwikflex@vsnl.net; Telefax : +91 251 2470102