

Sr.No	DESCRIPTION	MATL.	QTY.
1	BODY	SS316	1
2	CONNECTION	SS316	1
3	NOZZEL	SS316	1
4	SLEEVE	S.S.316	1
5	BALL	SS 316	6
6	LOCK RING	SS 316	1
7	SPRING	SS316	1
8	BODY SEAL	VITON	1
9	JOINT SEAL	VITON	1
10	POPJET	SS316	1
11	POPJET SEAL	VITON	1
12	SPRING	SS316	1

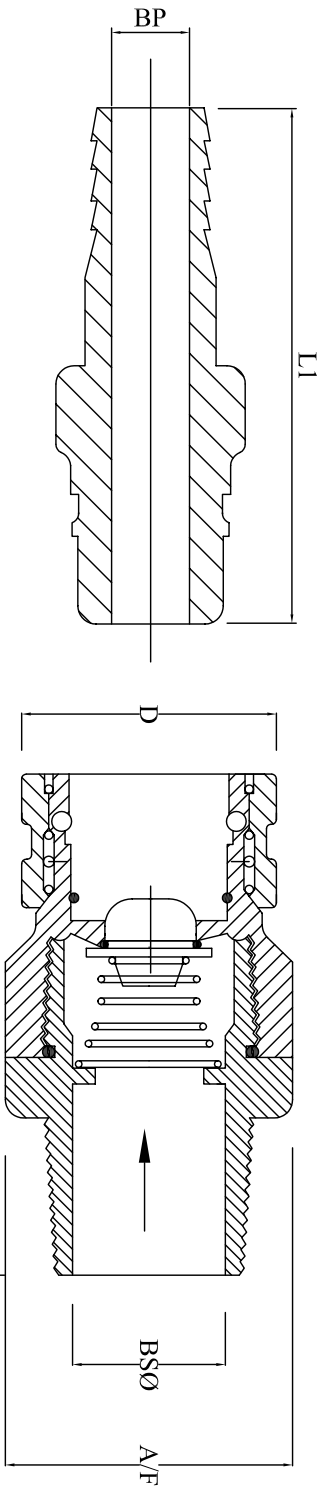

- MATERIAL : A479 SS316, A479 SS304, A105, MONEL, HASTELLOY.
- PORT CONNEC. : NPT, BSP, BSPT MALE AND FEMALE, TUBE END.
- SEAT SEAL : VITON
- JOINT SEAL : VITON, BUNA 'N'
- TEST PRESSURE : 25°C ROOM TEMPERATURE
- HYDROSTATIC : 100 Kg/cm²
- PNEUMATIC : 10 Kg/cm².
- FINISH : CS ZINC PLATED AND DICHROMATED, SS - NATURAL.

NOTE:
 * DIMENSIONS ARE FOR REFERENCE ONLY. SUBJECT TO CHANGE.
 ALL DIMENSIONS ARE IN MM UNLESS SPECIFIED

MODEL NO	SIZE	L1	BP Ø	L2	D Ø	E	A/F	BS Ø	L3
K303 QRC4	1/4"	47	5	56	22	13	19	7	86
K303 QRC6	3/8"	47	6	56	22	14	22	9	86
K303 QRC8	1/2"	65	9.5	73	32	16	28	13	112
K303 QRC12	3/4"	75	15	80	38	19	32	19	132
K303 QRC16	1"	80	19	85	44	21	38	22	140

REV	DESCRIPTION	DATE

TITLE : SINGLE CHECK QRC

DRN.	--	SCALE: NTS
CHK	--	
APPD.	--	DRG. NO.: KFL/.../...

KWIK FLEX INDUSTRIES
 AN ISO 9001 : 2008 COMPANY
 INDIA